

# FO SERIES REDUCING AND DIMENSION CHART

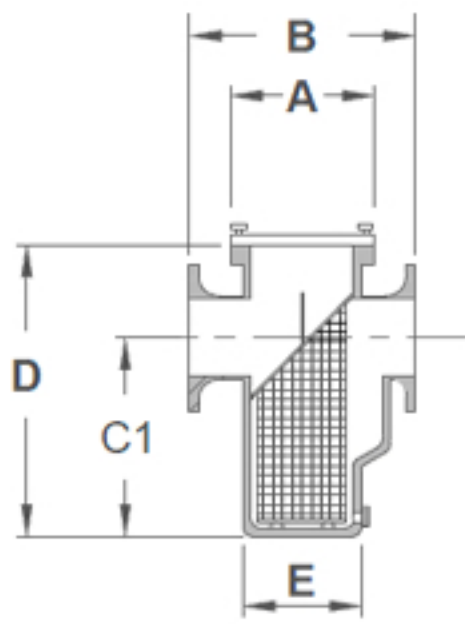

**STANDARD REDUCER**

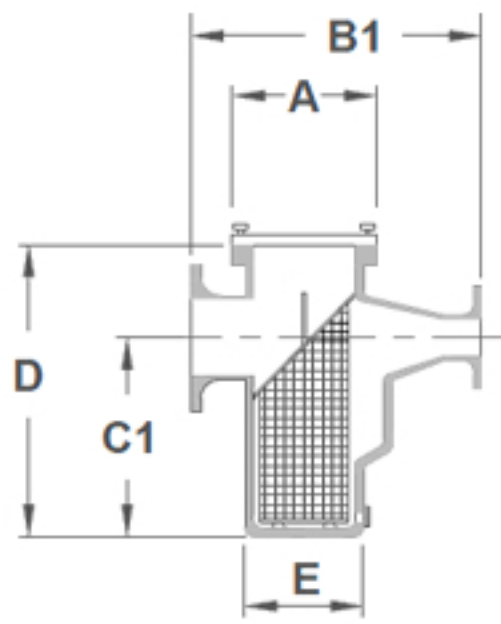

**CONCENTRIC REDUCER**

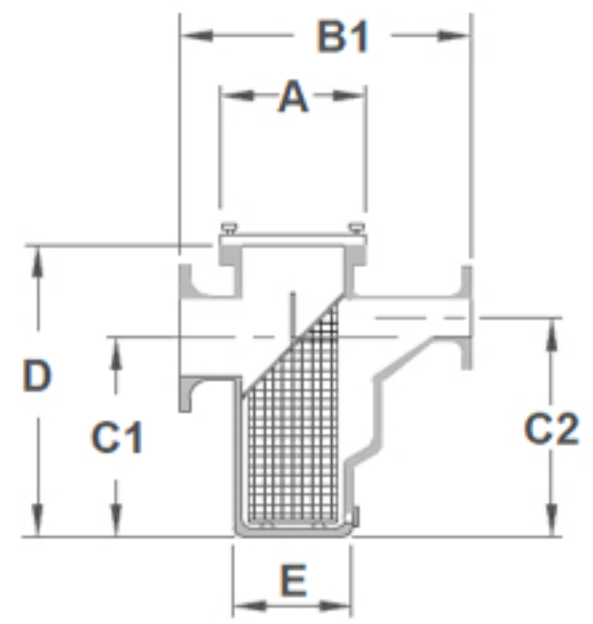

**ECCENTRIC REDUCER**

Inlet Dia.	Outlet Dia.	A	B	B1	C1	C2	D	E
4"	3"	9-1/4"	16-5/8"	20-5/8"	12"	12-1/2"	21-1/2"	7-1/4"
4"	2-1/2"	9-1/4"	16-5/8"	20-5/8"	12"	12-3/4"	21-1/2"	7-1/4"
4"	2"	9-1/4"	16-5/8"	20-5/8"	12"	13"	21-1/2"	7-1/4"
6"	5"	11-1/4"	17-5/8"	22-5/8"	15-1/2"	16"	25-1/4"	9-1/4"
6"	4"	11-1/4"	17-5/8"	22-5/8"	15-1/2"	16-1/2"	25-1/4"	9-1/4"
6"	3"	11-1/4"	N/A	22-5/8"	15-1/2"	17"	25-1/4"	9-1/4"
6"	2-1/2"	11-1/4"	N/A	22-5/8"	15-1/2"	17-1/4"	25-1/4"	9-1/4"
8"	6"	13-1/4"	23-1/2"	31"	17-1/2"	18-1/2"	30-1/4"	11-1/4"
8"	5"	13-1/4"	23-1/2"	31"	17-1/2"	19"	30-1/4"	11-1/4"
8"	4"	13-1/4"	N/A	31"	17-1/2"	19-1/2"	30-1/4"	11-1/4"
8"	3"	13-1/4"	N/A	31"	17-1/2"	20"	30-1/4"	11-1/4"
10"	8"	15-1/4"	28-3/4"	38-3/4"	21-1/2"	22-1/2"	34-3/4"	13-1/2"
10"	6"	15-1/4"	N/A	38-3/4"	21-1/2"	23-1/2"	34-3/4"	13-1/2"
10"	5"	15-1/4"	N/A	38-3/4"	21-1/2"	24"	34-3/4"	13-1/2"
10"	4"	15-1/4"	N/A	38-3/4"	21-1/2"	24-1/2"	34-3/4"	13-1/2"
12"	10"	17-1/4"	31-1/2"	41-1/2"	23"	24"	37-1/2"	15-3/4"
12"	8"	17-1/4"	N/A	41-1/2"	23"	25"	37-1/2"	15-3/4"
12"	6"	17-1/4"	N/A	41-1/2"	23"	26"	37-1/2"	15-3/4"
12"	5"	17-1/4"	N/A	41-1/2"	23"	26-1/2"	37-1/2"	15-3/4"
14"	12"	19-1/2"	36"	46"	26"	27"	42-1/8"	17-1/4"
14"	10"	19-1/2"	N/A	46"	26"	28"	42-1/8"	17-1/4"
14"	8"	19-1/2"	N/A	46"	26"	29"	42-1/8"	17-1/4"
14"	6"	19-1/2"	N/A	46"	26"	30"	42-1/8"	17-1/4"
16"	14"	23-1/4"	42"	52"	31"	32"	48"	21-3/4"
16"	12"	23-1/4"	N/A	52"	31"	33"	48"	21-3/4"
16"	10"	23-1/4"	N/A	52"	31"	34"	48"	21-3/4"
16"	8"	23-1/4"	N/A	52"	31"	35"	48"	21-3/4"
18"	16"	23-1/4"	42"	52"	31"	32"	48"	21-3/4"
18"	14"	23-1/4"	N/A	52"	31"	33"	48"	21-3/4"
18"	12"	23-1/4"	N/A	52"	31"	34"	48"	21-3/4"
18"	10"	23-1/4"	N/A	52"	31"	35"	48"	21-3/4"
20"	18"	23-1/4"	42"	52"	32-1/2"	33-1/2"	48"	21-3/4"
20"	16"	23-1/4"	N/A	52"	32-1/2"	34-1/2"	48"	21-3/4"
20"	14"	23-1/4"	N/A	52"	32-1/2"	35-1/2"	48"	21-3/4"
20"	12"	23-1/4"	N/A	52"	32-1/2"	36-1/2"	48"	21-3/4"